



**Art.-Nr: AGW009ML-AZ**

**Exit sign Centralised power supply systems**

**Wall mounting, Central power supply (ML), CPS, 50m, IP40,  
Zinc die-cast, Anthracite**

Modern zinc die-cast emergency exit sign luminaire for surface mounting on the wall and for identifying emergency and escape routes.

It is part of the A series luminaire family, which provides solutions for any mounting and has won the German Design Award for its uniform, straight-line design.

Control and monitoring via central power supply system. The requested pictogram (arrow to the right, left, up or down) is supplied as standard.



More information

[www.rp-group.com/en/item/AGW009ML-AZ](http://www.rp-group.com/en/item/AGW009ML-AZ)



## TECHNICAL DATA

Luminaire type	Exit sign
Mounting	Wall mounting
Recognition distance	50m
Pictograph	acc. to Specification
Illuminant	LED
Housing material	Zinc die-cast
Housing color	Anthracite
Protection type (IP)	IP40
Impact resistance (IK)	≥ 3
Certification	WEEE, CE
Insulation class	2
Supply	Centralised power supply systems
Monitoring	Central power supply (ML)
Bridging time	CPS
Battery	/
Operating mode	single luminaire switching
Input voltage AC	230 V
Input frequency	50 / 60 Hz
Input voltage DC	216 V



Power max.	6,1 W
Power DS	6,1 W
Power BS	1,1 W
Ambient temperature DS	-5 °C - 40 °C
Ambient temperature BS	-5 °C - 40 °C
Depth	51 mm
Width	517 mm
Height	296 mm
Weight	2.87
Weight incl. packaging	3.52
Connection cross-section	2.5 mm <sup>2</sup>
Switching input	Yes
Emergency light blocking	No
Battery connection	No
Dimming function	Yes
Customs tariff number	94056180
EAN	4260659565602



## TECHNICAL DRAWING

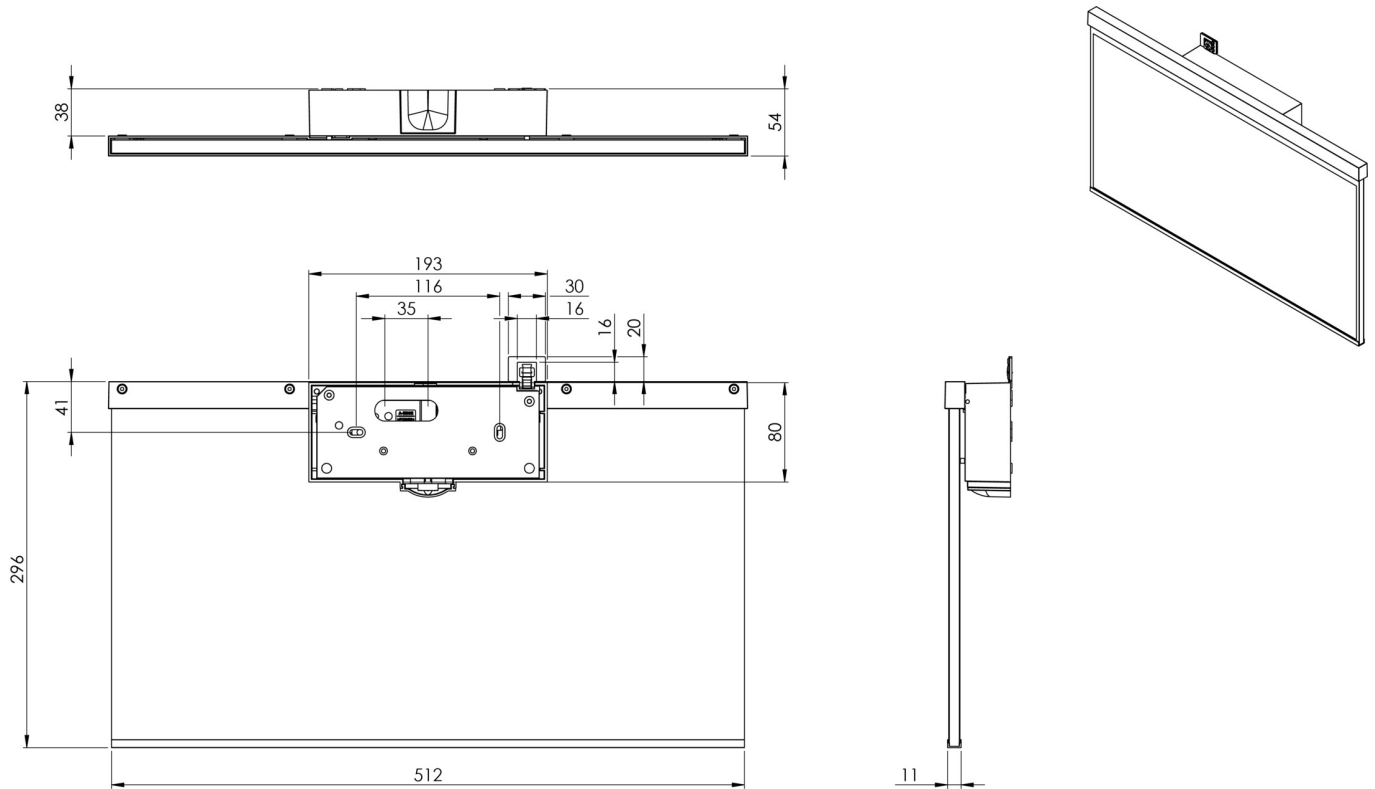

## RELATED PRODUCTS

Art.-No.	Image	Monitoring	Supply	Color	Investment	Automatic log	Maintenance level	Remote maintenance	max. luminaires	Single luminaire monitoring
AGW009ML		Central power supply (ML)	Central power supply	RAL 9003	€€€	Yes	low	Yes	1,920 per system	central
AGW009MLE		Central power supply (ML)	Central power supply	Edelstahl	€€€	Yes	low	Yes	1,920 per system	central

As of: 11.10.2024 - Subject to technical changes and errors.