



**Art.-Nr: AGW403WL-E**  
**Exit sign Single Battery**  
**Wall mounting, Wireless Professional (WL), 3 h, 50m, IP40,**  
**Zinc die-cast, Stainless steel**

Modern zinc die-cast emergency exit sign luminaire for surface mounting on the wall and for identifying emergency and escape routes.

It is part of the A series luminaire family, which provides solutions for any mounting and has won the German Design Award for its uniform, straight-line design.

Wireless central control and monitoring for large installations of up to 50,000 luminaires with Wireless Professional. The requested pictogram (arrow to the right, left, up or down) is supplied as standard.



More information  
[www.rp-group.com/en/item/AGW403WL-E](http://www.rp-group.com/en/item/AGW403WL-E)



## TECHNICAL DATA

Luminaire type	Exit sign
Mounting	Wall mounting
Recognition distance	50m
Pictograph	acc. to Specification
Illuminant	LED
Housing material	Zinc die-cast
Housing color	Stainless steel
Protection type (IP)	IP40
Impact resistance (IK)	≥ 3
Certification	WEEE, CE
Insulation class	2
Supply	Single Battery
Monitoring	Wireless Professional (WL)
Bridging time	3 h
Battery	LiFePO4 6,4 V/1,2 Ah
Operating mode	Standby circuit / permanent circuit
Input voltageAC	230 V
Input frequency	50 Hz



Power max.	7 W
Power DS	5,6 W
Power BS	0,8 W
Ambient temperature DS	-5 °C - 40 °C
Ambient temperature BS	-5 °C - 40 °C
Depth	51 mm
Width	517 mm
Height	296 mm
Weight	3.02
Weight incl. packaging	3.67
Connection cross-section	2.5 mm <sup>2</sup>
Switching input	Yes
Emergency light blocking	Yes
Battery connection	Connector
Dimming function	Yes
Customs tariff number	94056180
EAN	4260682152701



## TECHNICAL DRAWING

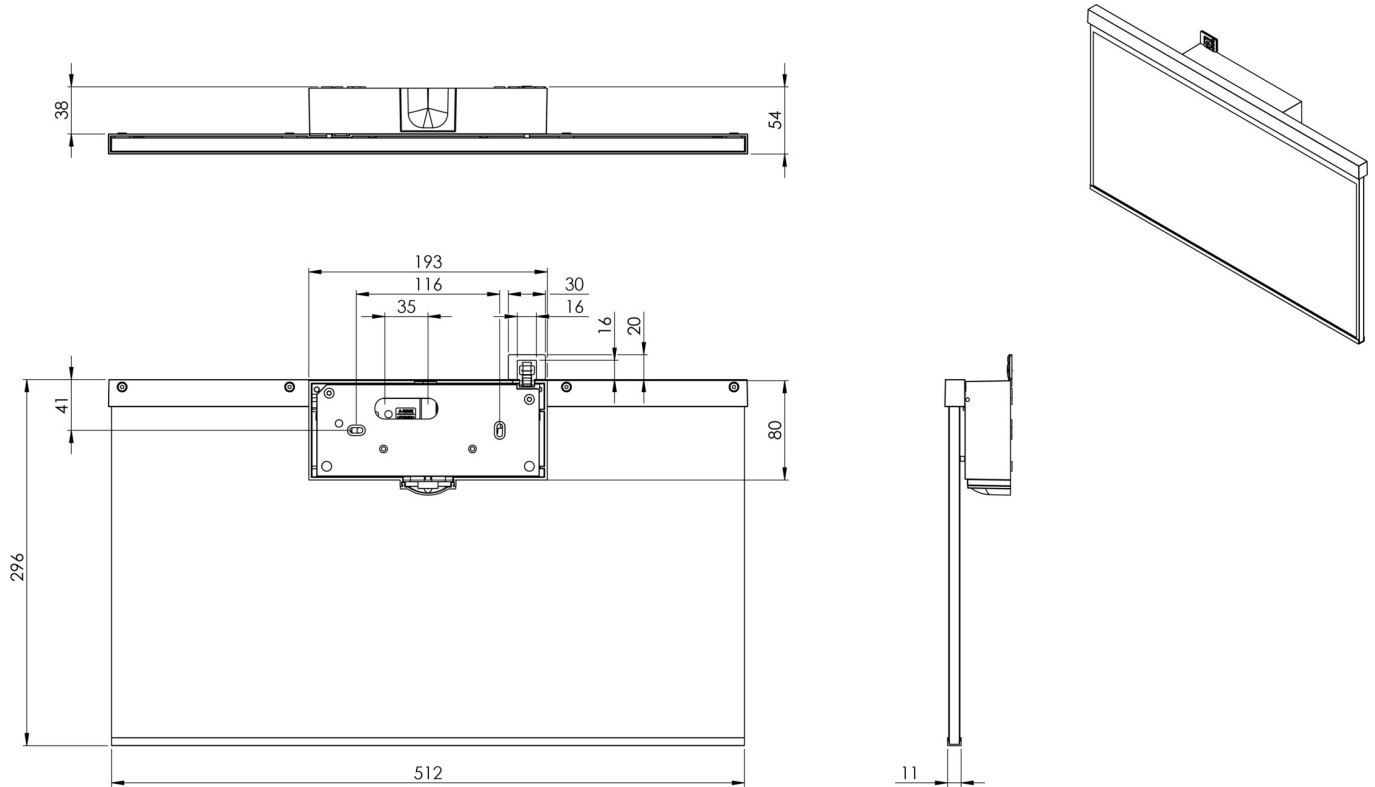

As of: 11.10.2024 - Subject to technical changes and errors.