



**Art.-Nr: KBU411WL**

**Exit sign, Safety luminaire Single Battery**

**Universal, Wireless Professional, 1 h, 14 m, 22 m, 30 m, IP64, Plastic, white**

LED exit sign / emergency light according to DIN EN 60598-1, EN 60598-2-22, EN 7010 and DIN EN 1838.

Cuboid plastic housing design reduced on the lamps substance. Modular design and universal mounting for use as emergency luminaire with and without the application of pictograms. The modular system allows the luminaire to be converted to an exit sign luminaire at any time without dismantling or tools. Panes for mounting pictographs have to be ordered separately.

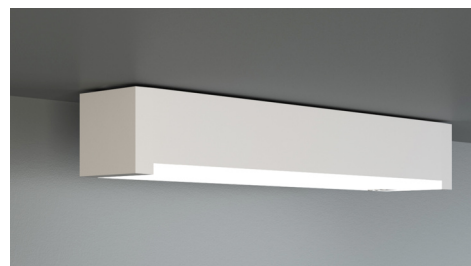

[More information](#)



## TECHNICAL DATA

Luminaire type	Exit sign, Safety luminaire
Mounting	Universal
Recognition distance	14 m, 22 m, 30 m
Pictograph	acc. to Specification
Illuminant	LED
Housing material	Plastic
Housing color	white
Protection type (IP)	IP64
Impact resistance (IK)	5
Certification	WEEE, TÜV Rheinland Type approved, CE, ENEC
Insulation class	2
Supply	Single Battery
Monitoring	Wireless Professional
Bridging time	1 h
Operating mode	Standby circuit / permanent circuit
Input voltageAC	230 V
Input frequency	50 Hz
Power max.	5,3 W
Power DS	4,3 W
Power BS	0,7 W



Depth	326 mm
Width	50 mm
Height	50 mm
Weight	0.47
Weight incl. packaging	0.52
Connection cross-section	2.5 mm <sup>2</sup>
Switching input	Yes
Emergency light blocking	Yes
Battery connection	Connector
Dimming function	Yes
Customs tariff number	94056120
Country of origin	DEUTSCHLAND
EAN	4260766556982

## TECHNICAL DRAWING

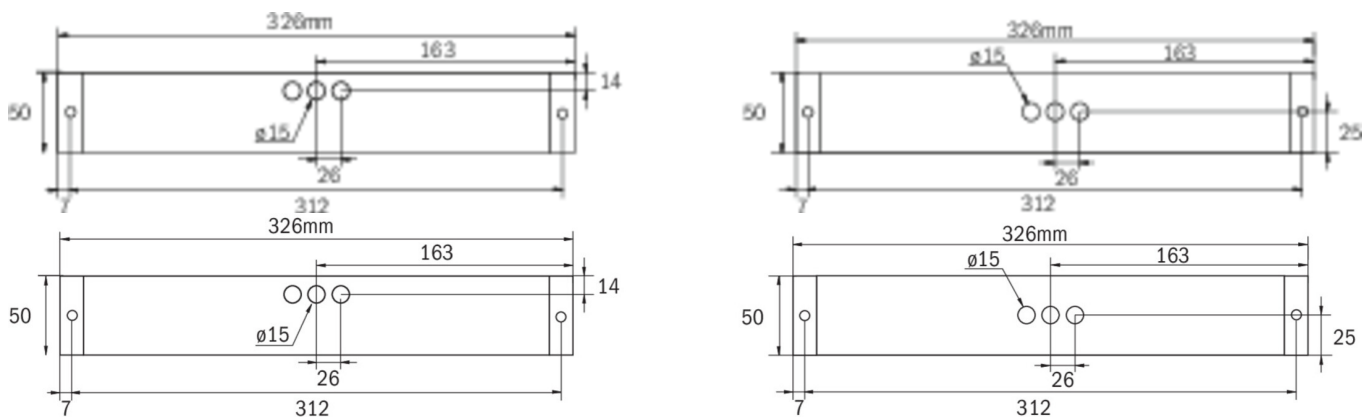

## ACCESSORY LIST

LFP3216-SET-2AKKU - Technology Battery

## RELATED PRODUCTS

Art.-No.	Image	Monitoring	Supply	Color	Investment	Automatic log	Maintenance level	Remote maintenance	max. luminaires	Single luminaire monitoring

As of: 08.07.2024 - Subject to technical changes and errors.