



**Art.-Nr: KMB411SC-TT**  
**Safety luminaire Single Battery**  
**Universal, SelfControl, 1 h, , IP54, Plastic, white**

Compact emergency luminaire for the illumination of escape and rescue routes with prismatic cover for optimized light distribution. This is made possible by the withe High-Power SMD LEDs wich also have an really long live spand of around 50000 h. These luminaires are available for central battery systems or as a selfcontained luminaire. The optional recessed mounting frame hides the luminaire elegantly within the ceiling.



[More information](#)



## TECHNICAL DATA

Luminaire type	Safety luminaire
Mounting	Universal
Pictograph	No
Illuminant	LED
Housing material	Plastic
Housing color	white
Protection type (IP)	IP54
Impact resistance (IK)	≥ 3
Certification	Waste disposal, CE
Insulation class	2
Supply	Single Battery
Monitoring	SelfControl
Bridging time	1 h
Operating mode	Standby circuit / permanent circuit
Input voltage AC	230 V
Input frequency	50 / 60 Hz
Input voltage DC	- V
Power max.	4,6 W
Power DS	3,3 W
Power BS	1 W
Depth	250 mm



Width	34 mm
Height	50 mm
Weight	0.5
Weight incl. packaging	0.57
Connection cross-section	2.5 mm <sup>2</sup>
Switching input	Yes
Emergency light blocking	No
Battery connection	Connector
Dimming function	No
Luminous flux mains	190 lm
Luminous flux emergency	85 lm
Country of origin	DEUTSCHLAND
EAN	4262483021071

## TECHNICAL DRAWING

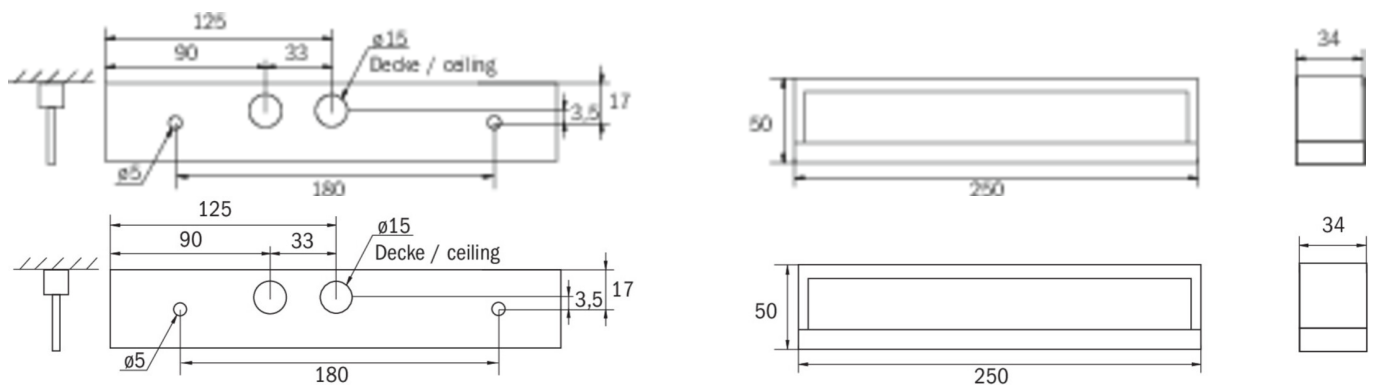

## ACCESSORY LIST

KME-EB -  
BALL1 -  
KMBE -  
BALLPLX-KMB -  
KMBFH -

As of: 29.06.2024 - Subject to technical changes and errors.