



**Art.-Nr: KMB411WB**  
**Safety luminaire Single Battery**  
**Universal, Wireless Basic, 1 h, , IP54, Plastic, white**

Compact emergency luminaire for the illumination of escape and rescue routes with prismatic cover for optimized light distribution. This is made possible by the with the High-Power SMD LEDs wich also have an really long live spand of around 50000 h. These luminaires are available for central battery systems or as a selfcontained luminaire. The optional recessed mounting frame hides the luminaire elegantly within the ceiling.



[More information](#)



## TECHNICAL DATA

|                        |                                     |
|------------------------|-------------------------------------|
| Luminaire type         | Safety luminaire                    |
| Mounting               | Universal                           |
| Pictograph             | No                                  |
| Illuminant             | LED                                 |
| Housing material       | Plastic                             |
| Housing color          | white                               |
| Protection type (IP)   | IP54                                |
| Impact resistance (IK) | ≥ 3                                 |
| Certification          | Waste disposal, CE                  |
| Insulation class       | 2                                   |
| Supply                 | Single Battery                      |
| Monitoring             | Wireless Basic                      |
| Bridging time          | 1 h                                 |
| Operating mode         | Standby circuit / permanent circuit |
| Input voltage AC       | 230 V                               |
| Input frequency        | 50 / 60 Hz                          |
| Input voltage DC       | - V                                 |
| Power max.             | 5,3 W                               |
| Power DS               | 3,9 W                               |
| Power BS               | 1,5 W                               |
| Depth                  | 250 mm                              |



|                          |                     |
|--------------------------|---------------------|
| Width                    | 34 mm               |
| Height                   | 50 mm               |
| Weight                   | 0.5                 |
| Weight incl. packaging   | 0.57                |
| Connection cross-section | 2.5 mm <sup>2</sup> |
| Switching input          | Yes                 |
| Emergency light blocking | No                  |
| Battery connection       | Connector           |
| Dimming function         | No                  |
| Luminous flux mains      | 190 lm              |
| Luminous flux emergency  | 190 lm              |
| Customs tariff number    | 94056180            |
| Country of origin        | DEUTSCHLAND         |
| EAN                      | 4260766559945       |

## TECHNICAL DRAWING

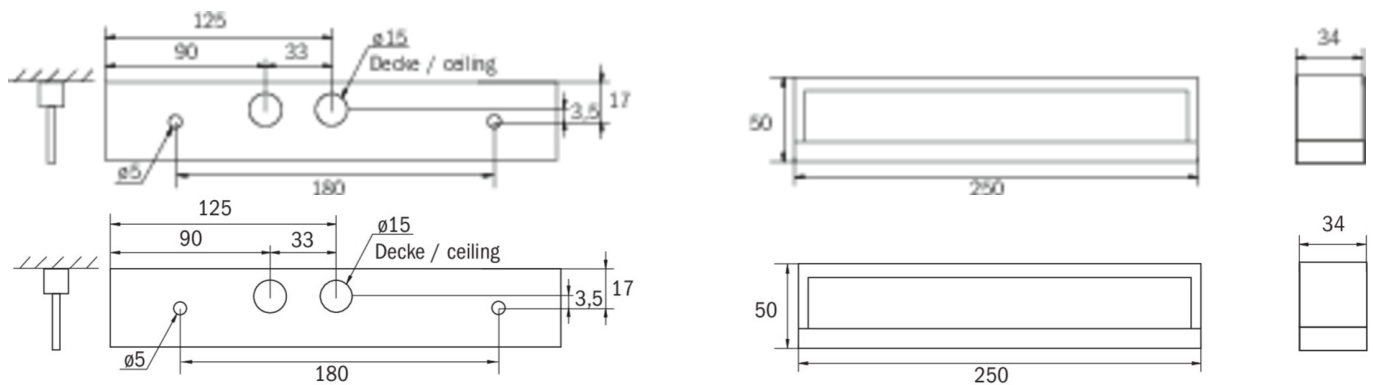

## ACCESSORY LIST

KME-EB -  
BALL1 -  
KMBE -  
BALLPLX-KMB -  
KMBFH -

As of: 29.06.2024 - Subject to technical changes and errors.